

1 Proposed Site Plan
1:100

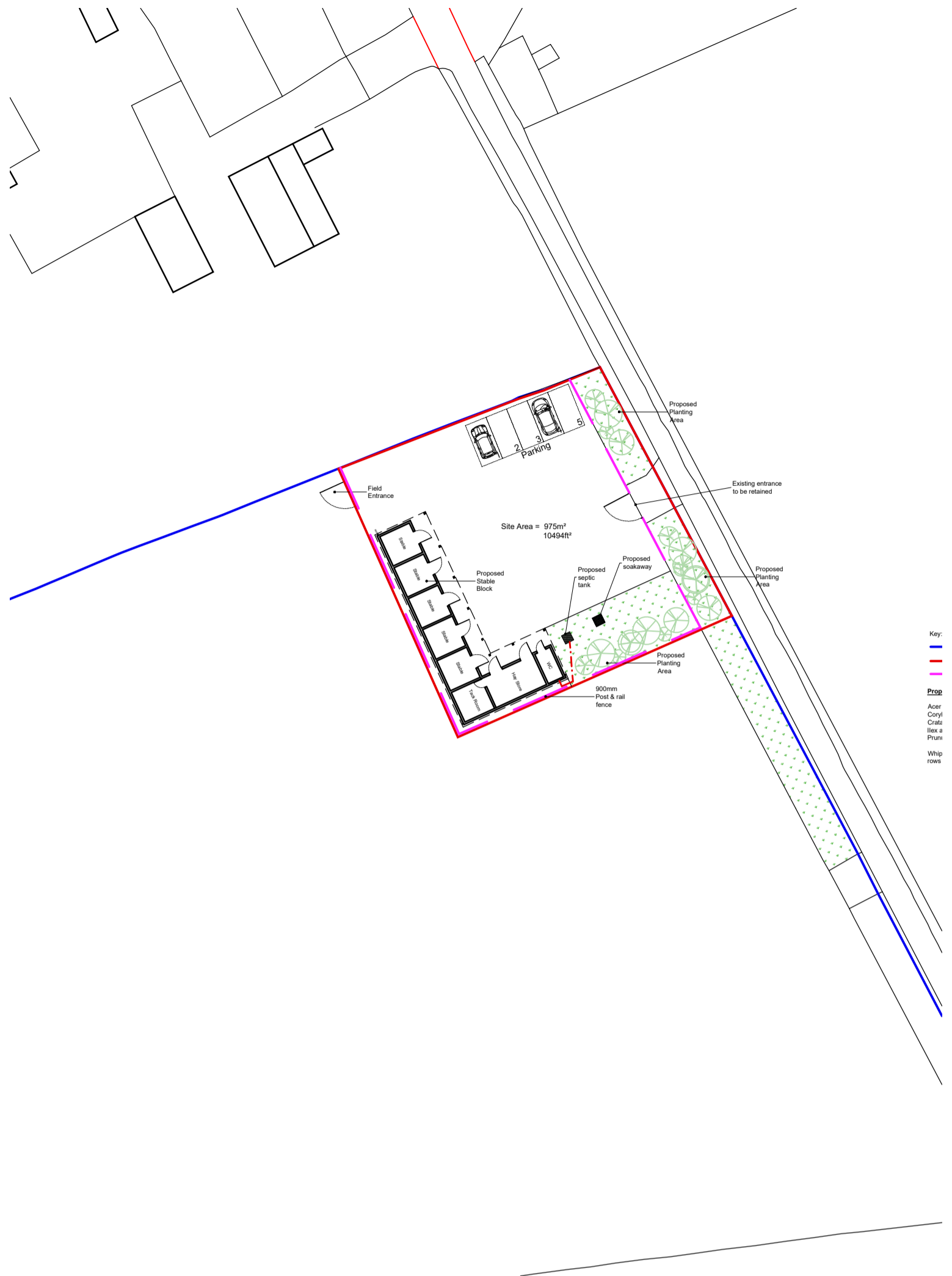

2 Block Plan
1:500



- Key:
- Land in client ownership
 - Application Boundary
 - Post and rail fencing

Proposed Planting Schedule

- Acer Campestre, 60-80cm, (10%)
- Corykus Avellena, 60-80cm, (10%)
- Crataegus monogyna, 60-80cm, (30%)
- Ilex aquafoilum, 60-80cm, (20%)
- Prunus spinosa, 60-80cm (30%)

Whips to be planted at 5 per linear metre in double staggered rows 500mm apart.

X	FIRST ISSUE	15.07.19	MB
Rev:	Details:	By / Chk:	Date:

Copyright of this drawing is vested in J Mason Associates and it must not be copied or reproduced without formal consent. Only figured dimensions are to be taken from this drawing. All contractors and sub-contractors are responsible for taking and checking all dimensions relative to their work and should not scale off this drawing.

Notify J Mason Associates immediately of any variation between drawings an site conditions.

USE FIGURED DIMENSIONS IN PREFERENCE TO SCALED - IF IN DOUBT ASK.

Where drawings are based on survey information received, surveys are available on request.

All drawings to be read in conjunction with all relevant Structural and M&E Engineers drawings and specifications.

H&S HAZARDS:

Significant hazards relative to the architectural design shown on this drawing have been assessed and highlighted with reasonable skill and care using a warning triangle system.

This drawing is to be read in conjunction with all other hazards/risks which have been identified and recorded within the construction phase H&S plan.

It is assumed that all works on this drawing will be carried out by a competent contractor working, where appropriate, to an approved method statement.

Significant hazards are defined as:-

- Those not likely to be obvious to a competent contractor or other designers.
- Those of an unusual nature.
- Those likely to be difficult to manage effectively.

J Mason Associates

www.jmasonassociates.com
Tel: 01543 487788
J Mason Associates
St. Thomas House, Wolverhampton Road,
Cannock,
WS11 1AR

J Mason Associates
Registered in England & Wales
5053992

Client:
Steve Kneller, Richard Dunkley

Project:
Stables, Land off Jacobs Hall Lane, Great Wyrley

Drawing Title:
Site Plan

Stage: RIBA 3	Status: Planning	Sheet Size: A1
Job Number: 2390	Date: 12.07.2019	Scale: As Noted
Revision: JMA-XX-SI-A-9002		-